

CERTIFIED RECORD OF LAND CORNER MONUMENTATION

History of original corner establishment:

The original corner was established in 1884 by Henry W. Cooke.

Set a basalt stone 14x14x5 ins. 9 ins in the ground for 1/4 sec cor marked 1/4 on W face and raised a mound of stone 1 1/2 ft high and 3 1/2 base alongside.

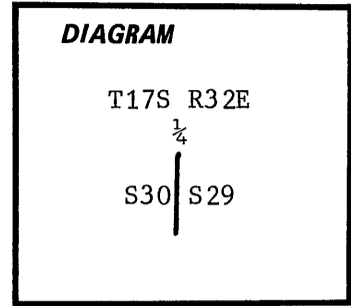

Description of corner evidence found:

Found a 15x10x5 stone with a broken corner marked 1/4 with a mound of stone to the West.

Description of monument and accessories I established to perpetuate the original location of this corner:

Set a 3 1/4" x 30" USDA aluminum monument with magnet 12" in the ground in a mound of stone. I used the original mound of stone to construct the new mound and placed the original stone in the mound.

CAP MARKED

T17S R32E

1/4

S30 S29

PLS 1918

1985

15" Juniper bears N 70 E, 368.4 feet scribed 1/4S29BT, with a 3/4" brass washer marked "LS 1918" between the B & T.

2" aluminum monument on rebar bears N 45 W, 25.0 feet stamped T17S R32E 1/4 S30 RM S45E 25.0 PLS 1918 1985.

Painted face and band red on the bearing tree and attached Attention sign and BT tag. Bearing tree measurements were made to the center of the tree.

Set a steel fence post with Attention sign South 3 feet.

Work performed 18 May 1985

Witness: Louise H. Parsons

Tyler B. Parsons, PLS 1918
1915 SE Stone Street
Corvallis, OR 97333
(503) 7527515

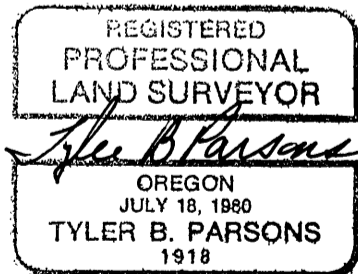

Road Cadastral Survey, Cont No 53-04H1-4-9665 N

Office of Surveyor County of Grant
 State of Oregon, I hereby certify that the within instrument was filed in this office
 for record on the 17 day of June, 1985
Robert D. Begett by _____
 (COUNTY OFFICIAL) (DEPUTY)